

BOSS PRODUCTS
A Division of Northern Star Industries, Inc.
P.O. Box 787 Iron Mountain MI 49801-0787
www.bossplow.com

**2006 & NEWER
CLUB CAR XRT 1550
RT3 UNDERCARRIAGE
MOUNTING INSTRUCTIONS
(PART NO. LTA12680)**

DRIVEN TO BE THE BEST

MSC12689-0

WARNING

Always follow the vehicle manufacturers' recommendations relating to system installation.

Due to the variety of equipment that can be installed on this vehicle, it is necessary to verify that the Front Gross Axle Weight Rating (FGAWR), Rear Gross Axle Weight Rating (RGAWR), and the Gross Vehicle Weight Rating (GAWR) are not exceeded at any time. This may require weighing the vehicle and adding ballast as necessary. It may also limit payload capacity of the vehicle. It is the operator's responsibility to verify that these ratings are not exceeded.

2006 & NEWER CLUB CAR XRT 1550 RT3 UNDERCARRIAGE MOUNTING INSTRUCTIONS

The mounting procedure outlined below covers 2006 & NEWER CLUB CAR XRT 1550 models. You will need to refer to the illustrations and familiarize yourself with each of the undercarriage components and their relative position to each other. Then proceed as follows:

1. Remove four existing bolts that attach Front Bumper to front of vehicle. Remove bumper and set aside. Front plastics may need to be loosened and pulled forward in order to make room for Skidplate Assembly (75) installation.

2. Align four top holes in Skidplate Assembly (75) with holes in Front crossmember of frame. Using M10 x 1.25 – 90mm Hex Head Bolts (I), and M10 - 1.25 nylon lock nuts (H), attach Skidplate Assembly with Spacer Plate (63) between Skidplate Assembly (75) and Front crossmember. Leave finger tight.

NOTE: If vehicle is equipped with a front hitch receiver, Spacer Plate (63) is NOT needed.

3. Align holes in back of Skidplate Assembly (75) with two holes in back of Differential mount plate. Using M12 x 1.25 – 60mm Hex Head Bolts (G), ½" washers (E), 7/8"x5/8"x1" Spacers (75A), and M12-1.25 nylon lock nuts (F) attach Skidplate Assembly (75) to Differential mount plate. Leave finger tight.

4. With Skidplate Assembly in place, tighten back two bolts M12 x 1.25 – 60mm (G) first, and then proceed to tighten front four bolts M10 x 1.25 – 90mm (I).

NOTE: The proper height adjustment for the Pushbeam (62) is approximately 17" from the ground to the center of Pushbeam (62) pin-receiving hole (See Figure 2) for Plow System.

5. Using 3/8"-16 X 1" Hex Head Bolts (A), 3/8"-16 Nylon Lock Nuts (C), ½"-13 X 1-1/2" Hex Head Bolts (B), and ½"-13 Nylon Lock Nuts (D), mount Pushbeam Assembly (62) to Skidplate Assembly (75).

6. With all undercarriage parts in place, securely fasten all remaining mounting hardware. It is important that all fasteners be properly torqued (See Figure 3) to assure a safe operating plow. Retighten all fasteners after two hours of plowing.

7. Add BOSS decal to front of top tube on Pushbeam Assembly (62).

2006 & NEWER CLUB CAR XRT 1550 RT3 UNDERCARRIAGE INSTALLATION PROCEDURE

REF. NO.	DESCRIPTION	PART NO.	QTY.
62	Pushbeam Assembly	PBA12535	1
75	Skidplate Assembly	LTA12681	1
63	Spacer Plate	LTA12688	1
75A	Spacer 7/8"x5/8"x1"	LTA12694	2
Includes:			
	FASTENER KIT,UC,UTV,CLUB CAR XRT 1550	HDW12690	1
A	HHCS,3/8-16X1,NC,GR5,PLT	HDW01717	6
B	NUT,3/8-16,NYL INS,YZN	HDW01720	6
C	HHCS,1/2-13X1-1/2,NC,GR5,YZN	HDW01728	4
D	NUT,1/2-13,NYL INS,YZN	HDW01748	4
E	Washer, 1/2,F436 HARD,F/W,YZN	HDW01729	4
F	NUT,M12-1.25,DIN985,NYL INS,YZN	HDW12668	2
G	HHCS,M12-1.25X60MM,GR10.9,YZN	HDW12691	2
H	NUT,NYL INS,M10-1.25,YZN	HDW12692	4
I	HHCS,M10-1.25X90MM,GR10.9,YZN	HDW12693	4

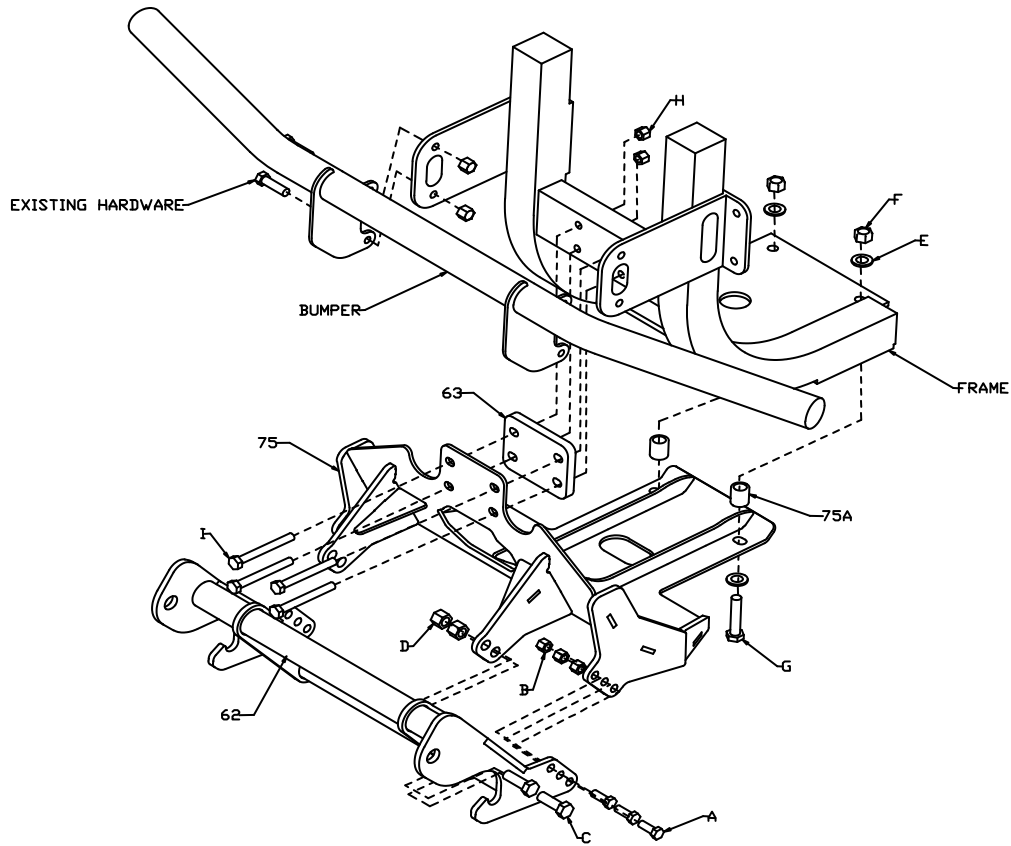

Figure 1

G10683

RECOMMENDED PUSHBEAM HEIGHT

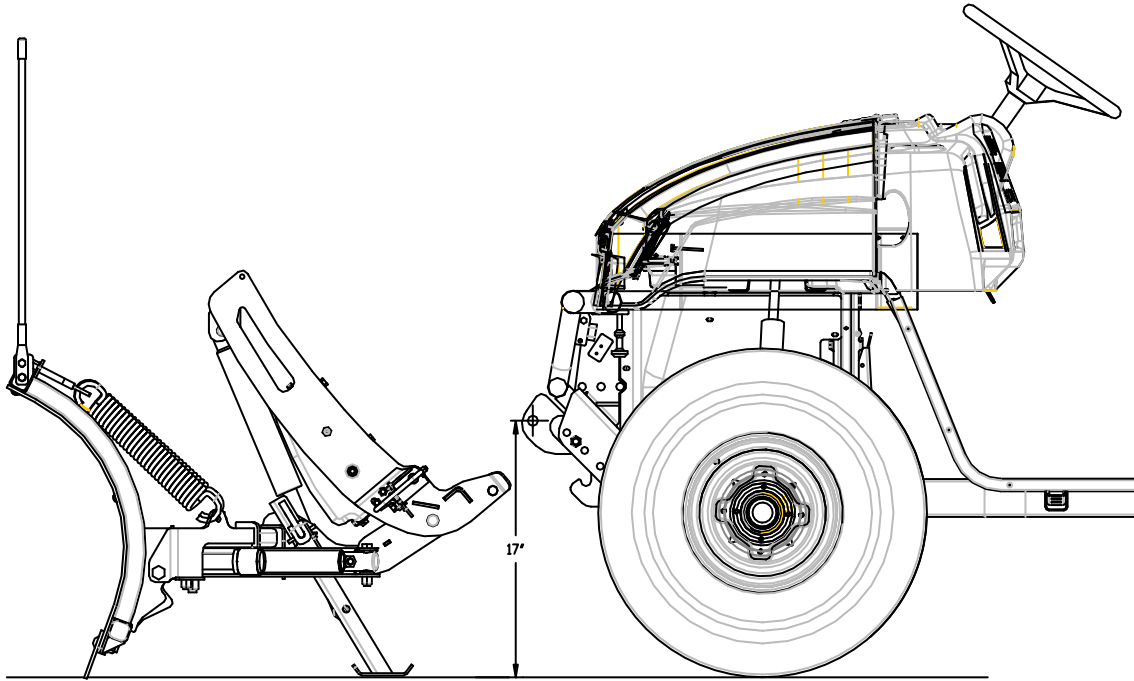

Figure 2

G10502

GUIDE TO RECOMMENDED ASSEMBLY TORQUE



DIAMETER / PITCH	GRADE 5	GRADE 8	GRADE 8.8	GRADE 10.9
1/4-20	6	9		
5/16-18	14	19		
3/8-16	23	33		
7/16-14	38	53		
1/2-13	56	80		
9/16-12	82	116		
5/8-11	113	159		
3/4-10	201	283		
M10 X 1.25			36	
M10 X 1.5				49
M12 X 1.25				92
M12 X 1.75				86
M14 X 2.0				136
M16 X 2.0				210

ALL TORQUE VALUES ARE IN FOOT-POUNDS (FT.-LB.)

Figure 3

G10668

* The torque values listed above are based on dry, coated bolts, variables such as oil, or other lubrications may appreciably alter these values and must be taken into consideration.

NOTE: IT IS IMPORTANT THAT ALL FASTENERS BE PROPERLY TORQUED TO ASSURE A SAFE OPERATING PLOW. RE-TIGHTEN ALL FASTENERS AFTER 2 HOURS OF PLOWING.